

LUXATO



Owner's User Manual

.....

For LUX 16

.....

THANK YOU FOR
CHOOSING US TO
FULFILL YOUR
HEARING NEEDS.



Enjoy!

Contents

Introduction	1
Components	2
Preparation	3
Operation	4
How to charge your hearing aids	4
How to wear your hearing instrument	6
ON and OFF function	9
Volume Control	9
Memory Switch	10
Maintenance	11
Troubleshooting	11
Cleaning	12

Introduction

Congratulations! Welcome to a new low carbon product, a rechargeable hearing instrument created by Luxato Hearing. Please read this user manual completely before use. This user manual only applies to the LUX 16 rechargeable personal sound amplifier.

Intended Use

The LUX 16 hearing amplifier is an electronic device which amplifies sounds from the surrounding environment. It will help individuals with mild to moderate hearing loss or those who just want to enhance their ability to hear conversations in a noisy environment. This rechargeable hearing device is intended to make daily use more convenient and the elimination of having to change the batteries every week. You can rest assured knowing the lithium polymer battery is eco-friendly and when properly maintained can last a very long time.

Precautions

For customers with ear infection, it is suggested not to wear hearing instrument until cured or by following a doctor's advice. Please consult with your hearing healthcare professional first if you have any questions about your hearing or your hearing instrument.

THE MANUFACTURER RESERVES THE RIGHT TO MODIFY THE TECHNICAL SPECIFICATIONS OF THE PRODUCT.

Components



Preparation

What's In the Box?

1 x LUX 16	1 x Earhook Kit
1 x Charger Adaptor	1 x Right Tube
1 x EZcharge® Micro-USB Cable	1 x Left Tube
1 x User Manual	1 x M/L Open-dome
1 x Quick Guide	1 x S/M/L Closed-dome
	1 x M/L Magic-dome
	1 x Cleaning wire & brush

Batteries

1. Power is supplied by a lithium polymer battery and should not be removed, except by an authorized service center.
2. A full charge takes approximately 2 hours and will allow for up to 20 hours of use.
3. The recharging process will automatically shut off when the battery is fully charged.
4. To maximize the extended life of the battery, keep the hearing aid plugged into the charger when not in use for an extended period.

Warning: DO NOT ATTEMPT TO REPLACE THE BATTERY BY YOURSELF. CONTACT YOUR HEARING AMPLIFIER PROVIDER. 3

How to Charge Your Hearing Instrument

Charging the hearing instrument is similar to charging a cellphone.

1. The USB cable supplied with the hearing aid has on one side the micro-USB connector and this will fit into the end of the hearing aid to charge it. On the other end of the cable is the full USB connector and this will plug into the supplied AC power plug connector, a computer USB port or any other standard USB power source used for charging other electronic devices.

Warning: Only use the charging kit provided to charge this device. Using any other charging tools may cause the device to melt.

2. We recommend that you fully charge the hearing instrument before using it for the first time.

3. When the USB cable is connected to a power source and the micro-USB connector is inserted in the hearing instrument, there will be a **blue** LED light that will glow to indicate that the hearing instrument is being charged. When the instrument is fully charged, the LED indicator will be **green** and ready to use. There is no harm by leaving the hearing instrument connected to the power source after it is fully charged, since the advanced circuitry regulates and monitors this condition.

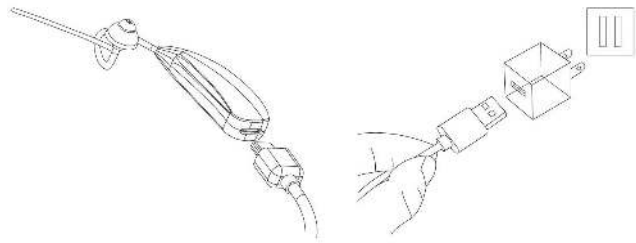

Full charging time: Approximately 2 hours

Duration of use: Approximately 20 Hours of normal use under maximum volume cycle times: No decline within 500 times

- Less than 15% decline over 500 times
- Less than 75% decline over 1000 times

Notice: If you need to use the hearing instruments before the charging cycle is complete, the operation time can be shorter than usual.

How to Wear Your Hearing Instrument

Attaching your hearing instrument parts

Fig. 1

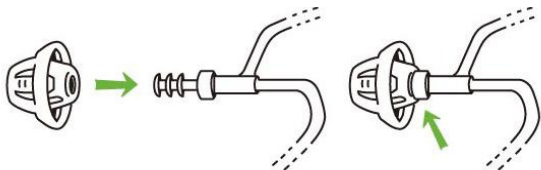

Your hearing instrument consists of three basic parts: The hearing instrument housing, the sound tube, and the dome.

To attach the dome (Fig. 1), push the dome completely over the grooves on the tube to mount it securely.

To attach the sound tube (Fig. 2), hold the connector end of the sound tube in one hand and the hearing instrument in the other, and twist the tubing into the hearing aid until properly secured.

Note: Your hearing amplifier is supplied with two tubes.

RED lettering is for right ear

BLUE lettering is for left ear

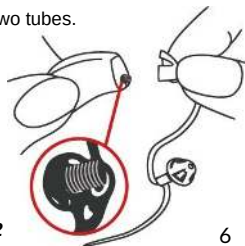

Fig. 2

Ear Hook Option

Attaching earhook parts

1. Choose the suitable dome and then push the dome completely over the grooves on the tube to mount it securely.

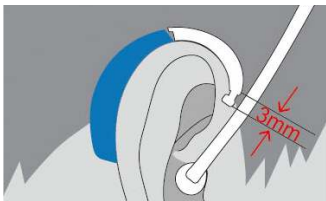
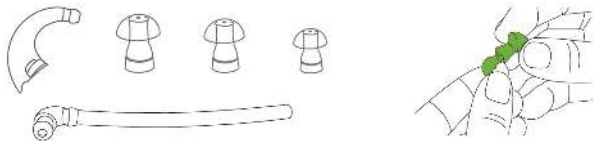
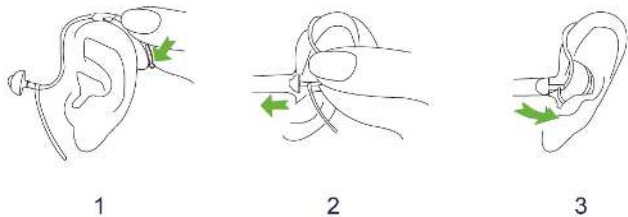

Fig. 3

2. Mount the ear hook to the hearing instrument housing by twisting it on until the two flat surfaces are flush together.

3. Position the hearing amplifier with the attached air hook over the ear as shown. Next, insert the dome attached to the tubing comfortably into the ear canal and align the tubing towards the end of the ear as shown in the picture. Mark the location where the end of the ear hook is on the tubing. Remove the hearing amplifier and the tubing from your ear and cut the tubing 0.2 inches (3mm) above the mark on the tube (Fig. 3).

Position your hearing instrument over ear



1. Place the hearing instrument over the top of your ear.
2. Hold the tube close to the dome with your thumb and forefinger. Insert the dome with gentle pressure into your ear canal until the tube sits flush against the side of the face. The dome should fit in the ear canal snug, but not tight.
3. Position the retention lock into the outer bowl of the ear above the ear lobe using your index finger.

ON and OFF function

Use the volume control knob to turn the hearing instrument on. Zero turns the hearing amplifier on and any volume number will turn on the device. Once on, you can press the Program Button once to cycle between the four preset amplification programs (pg. 10).

Volume Control

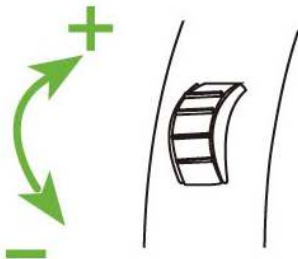

To adjust the volume, rotate the volume control up or down.

- The higher the number the higher the sound will be.
- To increase the volume, turn the volume control up.
- To decrease the volume, turn the volume control down.

Note: Before wearing the instrument, make sure that the volume is not at the maximum. It is recommended to start the volume on the lowest setting. Adjust the volume gradually according to your own hearing requirements, but not so loud as to cause feedback.

Memory Switch

Your hearing amplifier can be programmed with up to 4 different listening programs. When the hearing instrument is turned on, it will automatically be in program 1.

The additional settings which are pre-programmed for your specific needs are accessed by the memory switch. Each time you press the memory switch, the hearing instrument will move to the next program. The sequence is 1, 2, 3, and 4. The LUX 16 is equipped with the adaptive directional microphones function. Adaptive directional microphones can provide improved speech recognition in noise.

Program 1: Single microphone mode

Program 2: Dual microphone mode

Program 3: Single microphone TV mode

Program 4: Dual microphone OUTDOOR mode

Your hearing amplifier will alert and help you identify which program you are using. When you select program 1 you will hear one beep, program 2 will emit two beeps, and so on.

Note: The programs are preset by the manufacturer.

Maintenance

Troubleshooting

1. How to charge the device?

Connect the device with the Micro-USB cable provided to the AC adapter and plug into an outlet or plug into computer's USB port.

2. How long does it take for the device to be fully charged?

It takes approximately 2 hours to fully charge this device.

3. How long is the working time of the device after fully charged?

The device can work for about 20 hours after fully charged under quiet environments in loud surroundings, it takes more power for the hearing instrument to filter out sounds and thus may have a shorter usage time, but it will not diminish drastically.

4. Why the device is not working during the charging phase?

The device will be turned off automatically to make for a faster charging time. It is recommended that you turn off the hearing instrument when it is not in use to prevent the battery from discharging totally and to prevent any feedback noise.

5. How to know when the hearing device is fully charged?

When the device starts to charge, the LED indicator light will glow and when the device is fully charged, the light will turn off.

6. How to maintain the hearing instrument charging system?

To get the maximum use from the internal battery, it is recommended that the hearing instrument is charged daily which is typically overnight. It is also recommended that if the hearing instrument is not used for an extended period throughout the day, that the hearing instrument is turned off or plug the hearing instrument into the USB cable and power source.

7. Can the user replace the battery?

The user cannot replace the battery since it is sealed inside the case. If the hearing instrument needs service, **please call us at (877) 320-6917.**

8. When do I use the Earhook?

Your hearing device comes assembled with the standard thin tube and dome. If you notice your hearing is not loud enough using the thin tube, you can untwist the thin tube from the hearing device and begin using your earhook. The earhook has a thicker sound tube to allow more sound waves to enter.

Cleaning

Keep the hearing instrument clean and dry. Please use a soft cloth to clean and remove any body oil or moisture from the shell of the hearing instrument. If the hearing device is often in a moist environment or subject to a lot of perspiration it is recommended to put the hearing instruments that are turned off into a dry box at least once a week.

CALL US AT (877) 320-6917 TO ORDER YOUR HEARING AMPLIFIER TO ORDER YOUR DRY BOX.



Do not use water or other fluids to clean the hearing instruments.

There should always be care in handling the hearing instrument to prevent them from falling onto any hard surfaces, such as counter top, table or floor. Do not leave your hearing instrument in the direct sun or in areas where the temperature can rise over 60°C / 140°F for extended periods. Avoid cleaning with any harsh chemicals or strong cleaners.

Stop Using Hearing Amplifiers and Consult a Physician If:

- Hearing in one or both ears worsens.
- Your ear becomes occluded with excessive ear wax.
- Hearing does not improve while using the provided hearing aid.
- You develop an infection of your ear or ear canal.
- Skin irritation develops in or around your ear canal.



Hear **Today.** Hear **Tomorrow.**

Contact Us

www.LuxatoHearing.com
1+ (877) 320-6917
info@LuxatoHearing.com

Follow us on **Social
Media**

